

WALL WRAP & WALL WRAP BREATHER



PRODUCT INFORMATION

Wall Wrap & Wall Wrap Breather are specifically manufactured to the highest industry standards.

WALL INSTALLATION - Up to R1.1 may be added to the wall system when Wall Wrap & Wall Wrap Breather are installed as wall cladding behind brick

veneer/timber cladding. Our specialised manufacturing process bonds together Aluminium Foil to a high strength reinforcing Polymer Mesh using a flame retardant adhesive. Our Reinforcing Polymer Mesh is purposely treated blue in colour to reduce reflective glare problems when Wall Wrap & Wall Wrap Breather are installed.

- ☐ Satisfy BCA specifications and requirements for Reflective Foil Laminates.
- ☐ Complies with the specifications and requirements of AS/NZS 4200.1 for "Pliable Building Membranes" which is a manual recognised by the BCA Part 3.5 Roof and Cladding.
- ☐ Low Flammability Index in accordance with AS 1530.2 < 5
- ☐ Satisfy BCA Part 3.7.1 Fire Hazard Properties.
- ☐ Satisfy Health and Safety Regulations.

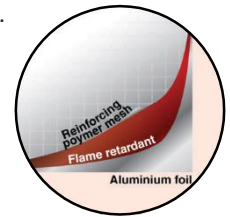

WALL WRAP &

WALL WRAP BREATHER USAGE

In all applications:

- External cladding should be installed A.S.A.P
- No contact is to be made with wet concrete or mortar
- Store in dry area, weather proofed only after installation
- Shrinkage of up to 2% can be expected

In reflective foil laminate applications:

- Use only in accordance with AS/NZS 4200. 2 for the "Installation Requirements for Pliable Building Membranes"
- Minimum of 20MM air space is recommended adjacent to reflective foil face to achieve Maximum insulation values

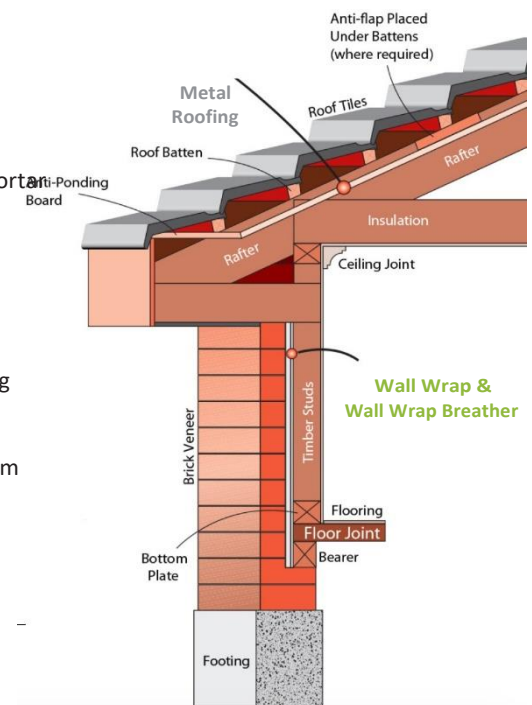

WALL WRAP & WALLWRAP BREATHER

THE ULTIMATE PROTECTION

Proudly Supplied by
GI Building Sciences

Sales 1300 308 165

Recommended Applications and Properties		
	Wall Wrap	Breather
Residential Wall Insulation	☐	☐
Commercial Wall Insulation	☐	☐
Duty	Heavy	Heavy
Vapour barrier	High	Low
Emittance	Reflective	Reflective
Water barrier	High	Unclassified
Flammability Index < 5	< 5	< 5
Tensile Strength Machine Direction (kN/M)	min 12.5	min 12.5
Tensile Strength Lateral Direction (kN/M)	min 7.5	min 7.5
Edge Tear Resistance Machine Direction (N)	min 80	min 80
Edge Tear Resistance Lateral Direction (N)	min 80	min 80
Water Vapour Transmission Rate (Ng/Ns)	max 2	min 140
Emittance of Reflective Face	max 0.05	max 0.05
Availability		
Width 1350mm Length 60m Area 81m ²	☐	☐
Width 1500mm Length 60m Area 90m ²	☐	☐

