



Product Spotlight Sheet

# Reflecta-Cell Plus™

greenguide

features and benefits reference



Phone: 1300 308 165

Fax: 1300 308 164

Web: [gibuildingsciences.com.au](http://gibuildingsciences.com.au)

## Reflecta-Cell Plus™ the original

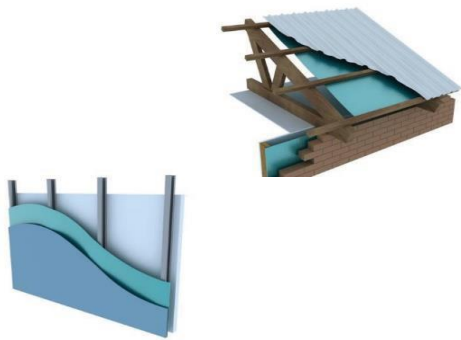

**Reflecta-Cell Plus™** is the first of the range created by **GI Building Sciences™**. Initially designed as an alternative to fibrous insulation materials.

**Reflecta-Cell Plus™** has continually proven to outperform conventional insulation materials and demonstrate greater longevity under harsh Australian climate conditions.

Suitable for almost every building type commercial or domestic, **Reflecta-Cell Plus™** offers great performance benefits for almost every building application.

Performance Comparison of Reflecta-Cell Plus™ to Competing Insulation Materials Flat Metal Roof 0-5° & Flat Plasterboard Ceiling				
Insulation		Summer (Downwards)	Winter (Upwards)	Thermal Break
1*	GI Building Sciences™ Reflecta-Cell Plus™	RT 3.1	RT 1.2	0.12
2*	60mm Glasswool Roofing Blanket	RT 3.5	RT 2.1	0.20
3*	Kingspan Insulbreak 65	RT 3.2	RT 1.4	0.20

1\*. Thermal calculations for GI products by James Fricker as per AS/NZS 4859.1&2 - Airspace 40mm & 300mm

2\*. Glasswool R Values source the Insulation Council of Australia & New Zealand Insulation Handbook V2, Jan 2015 - Airspace 300mm

3\*. Kingspan R Values source Kingspan Section J Compliance Solutions Brochure Issue 2, October 2013 - Airspace Range 100 – 1200mm

## Features – Fact vs Fiction

- 15 Year Warranty
- Suitable for Use in Residential and Commercial Walls and Roofs
- Class 2 Vapour Barrier
- 20m x 1500mm Roll
- AS 1530.2 & AS/NZS 1530.3 Compliant
- Structure enables it and Other Cellular Materials to be easily installed

## Key Benefits

- A Good Medium for Managing Condensation
- 1500mm Wide reduces Wastage compared to 1350mm Wide Foam Product
- Fully Recyclable
- Able to be Cut to Length for Major Projects
- Cost of Raw Materials More Stable than Foam ensuring Long Term Cost Competitiveness
- The Entry Level all-rounder suited to Commercial, Domestic or Shed Construction Projects

Products are to be stored standing upright and on pallets not more than two high. Product warranty is voided for any product stored horizontally resulting in squeeze or crush. Returns of product displaying effects of deformation due to incorrect storage practices will not be accepted.

